

# 9FT Wave B Series-Vertical Curved Frame To Install

## Frame Installation

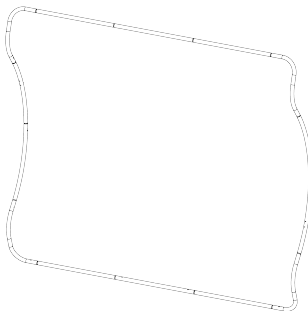
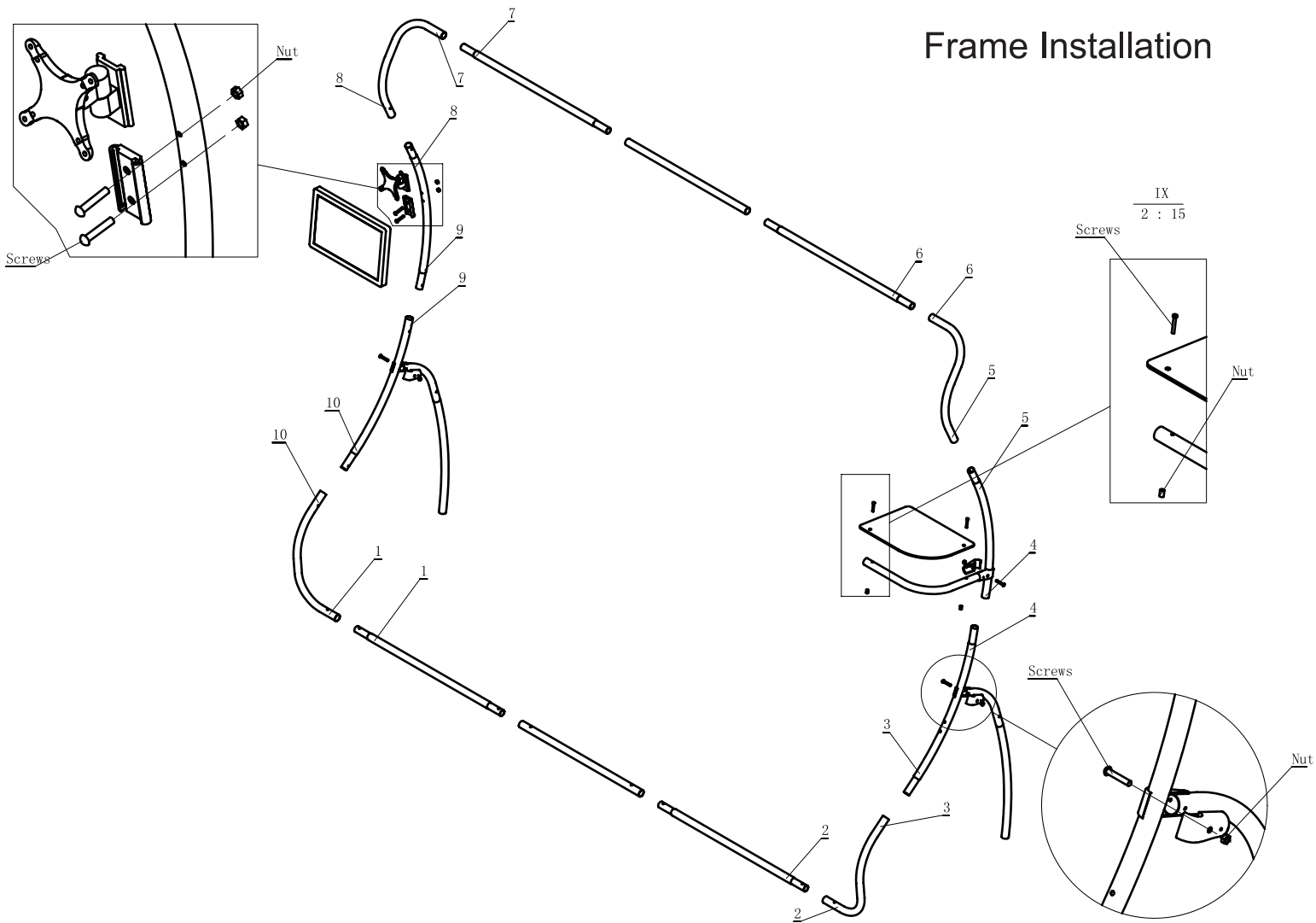

### STEP 1 :

There are some figures labeled on every tubes, connecting the same figures together to make up of the frame.  
(Please noted that don't install the leg now)

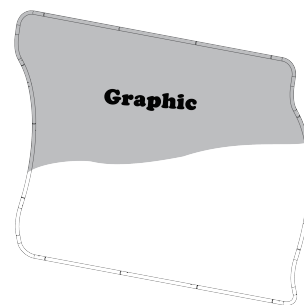

### STEP 2 :

Put the graphic on the ready frame.

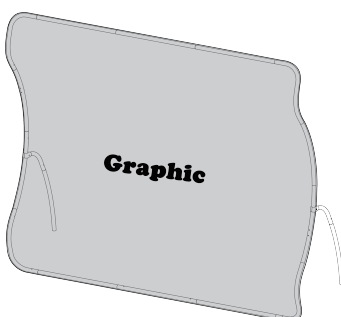

### STEP 3 :

Install the leg now.

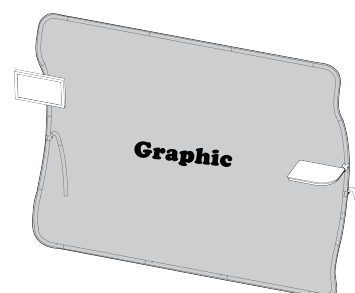

### STEP 4 :

Install the shelf and LCD mount on the frame.  
So that is completed.